

BLI Lighting Specialists

Click on below link for more information

LED Under Cabinet Lighting DDU28LED Diode28

DESCRIPTION

This undercabinet diode unit features with 28 LEDs (5W) watts led that can be adjusted with push button switch to full or half power.

CONSTRUCTION

High gloss ABS injection molded plastic housing. Frosted ABS injection molded diffuser. 28Diodes (5 watt) white LEDs. Unit can be adhesive or screw mounted. Has 3-position switch for full or half light output. Uses proprietary power connectors.

FINISH

Polished white housing with clear frosted diffuser.

DIFFUSER

Diffuser is 1/8" thick ABS material. Frosted texture on surface, clear over LEDs.

ELECTRICAL

Circuit board contains 28 white LEDs
 3500K, 60° beam spread
 One .25 watt blue LED for switch backlight
 LED AC/DC converter integrated PC board
 Must use proprietary power connectors
 3-position push switch
 20 Units (145W) Maximum to Interconnect

Fixture complies with U.L. 153
 UL listed for dry locations.

120volt, ±10%, 60Hz A.C.

ACCESSORIES

60" 18ga SPT-2 Power cable with connector (Included)
 12" Interconnect Cable (Included)
 Two #6 screws for mounting to metal or wood (Included)

Option:

Four 1" sq adhesive pad for mounting to painted surfaces (Included)
 Hardwire Box - 120V In-Line Power (Not Included)
 Model No. XNHB Series

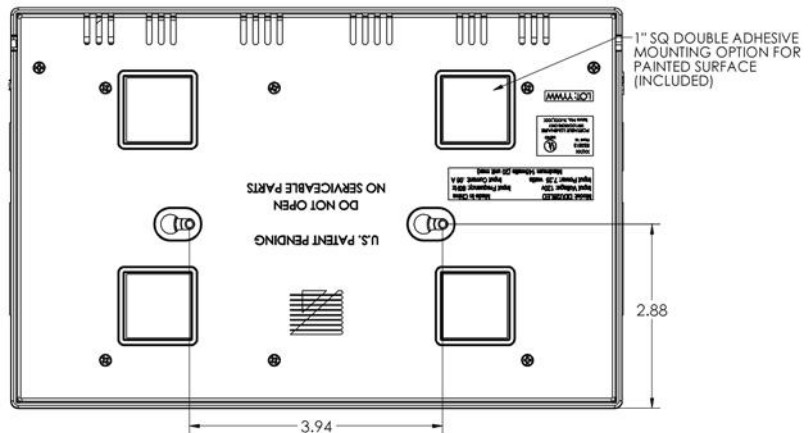
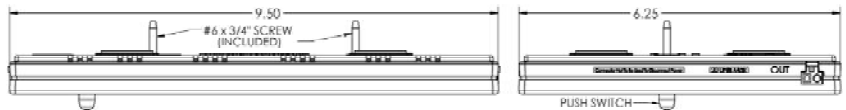
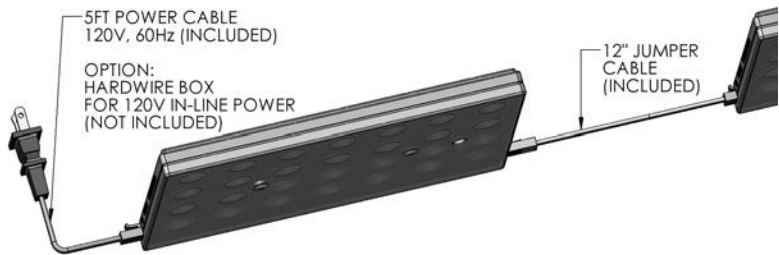

ORDERING INFORMATION

| Model No. | LED | W | D | H |
|-----------|-------------------|--------|--------|------|
| DDU28WH | 28Diodes (5 watt) | 9-1/2" | 6-1/4" | 5/8" |



Warranty - "Ballasts are covered by separate manufacturers warranties. Any labor allowance regarding ballasts must be approved by the factory."

XNHB SERIES

DESCRIPTION

This hardwire box is for use with American Fluorescent SL series fluorescent and XNK series xenon undercabinet task lights. A convenient method to only make one hardwire splice yet have the capability to interconnect fixtures. Comes standard with on/off rocker switch and 3/8" hardwire connector.

CONSTRUCTION

Housing and cover is molded from .125" thick high impact white thermoplastic.

ELECTRICAL

The system is U.L. listed for BX/Romex or similar clamp for indoor Dry applications and only for connecting to American Fluorescent SL8, SL13 and XNK series fixtures.

FOR Model No: **SL8 / SL13** Series:

- Do not interconnect more than 200 watts
- Example: 200 watts (25 lamps x 8w)
- Example: 200 watts (15 lamps x 13w)

FOR Model No: **XNK** Series:

- Do not interconnect more than 576 watts
- Example: 756 watts (32 lamps x 18w)

Note: For normal installation, install hardwire box to the right hand side of the fixture run. There are 2 "IN" connector on the hardwire box for various applications.

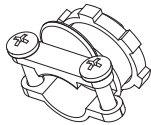

3/8" CONNECTOR

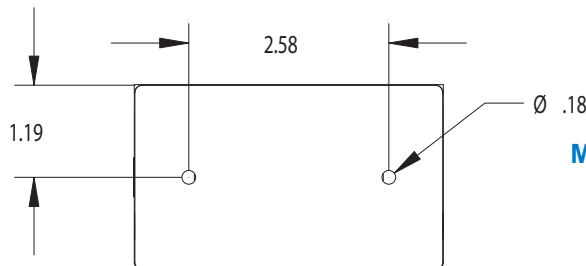
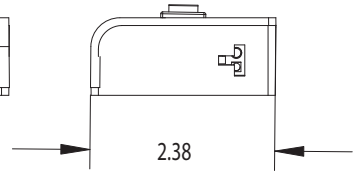
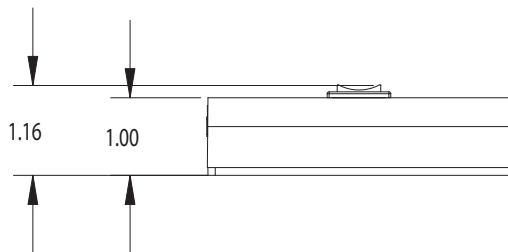
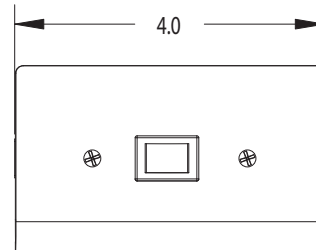
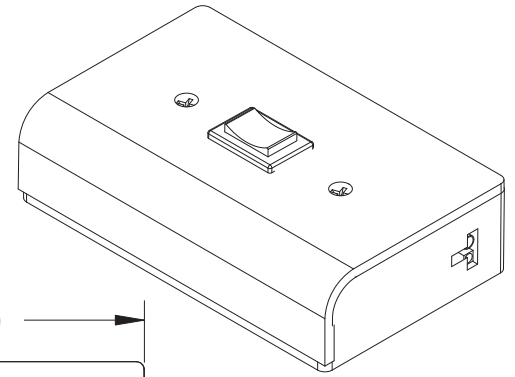

MOUNTING DATA

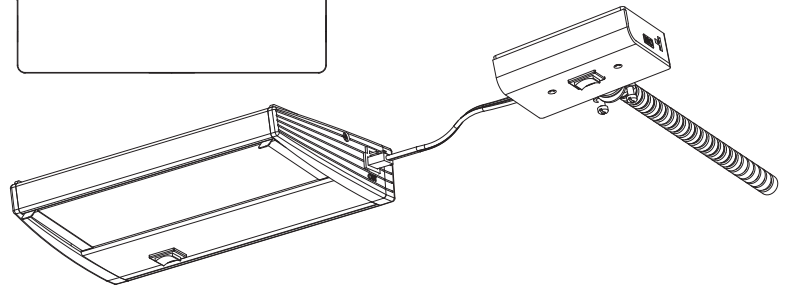

ACCESSORIES

Contact your local distributor for availability of the interconnecting cables



CONNECTING CABLE

ORDERING INFORMATION

| Model No. | Description | DIMENSIONS | | |
|-----------|--------------|------------|--------|--------|
| | | L | W | D |
| XNHBW | Hardwire box | 4" | 2 3/8" | 1 1/2" |

ACCESSORIES

| Model No. | Description |
|-----------|----------------------|
| XNCC12W | 12" Connecting Cable |
| XNCC24W | 24" Connecting Cable |

